

**LOGKRAFT™**

REVOLUTIONISING INTRALOGISTICS

STORAGE RANGE CATALOGUE

# Why Choose us

We are one of the leading intralogistics solutions provider. Our product portfolio includes- Racking, shelving, warehouse design & MHE.

- ✓ At Logkraft India Pvt Ltd, we are committed to provide specialized racking & material handling solutions for across segment industries as per current industry norms & changing trends.
- ✓ Our customized, state of the manufacturing facility can cater to across segment industries for all their storage needs.
- ✓ With experienced solution design team and controller process at each level of value chain i.e. purchase, quality, production and delivery makes our products a “Big go to” for all our clientele.
- ✓ Warehouse automation can increase efficiency, accuracy, speed, and safety. It can also reduce labor costs and improve inventory management.





# Our Product Range

## PALLET RACKING SYSTEM

- Selective PRS
- Drive In PRS
- Double Deep PRS
- Shuttle System
- Mobile Racking



## MANUAL PICKING SHELVING

- Slotted Angle Shelving
- Long Span Shelving System - Medium/Heavy
- Boltless Shelving System
- Multi - tier Shelving System



## CANTILEVER RACKING



## MEZZANINE STRUCTURE

### OUR MHE RANGE

- Hand Pallet Trucks
- B0PT
- Stacker
- Forklift
- Reach Trucks
- Articulated Forklift
- Side Loaders
- VNA Trucks

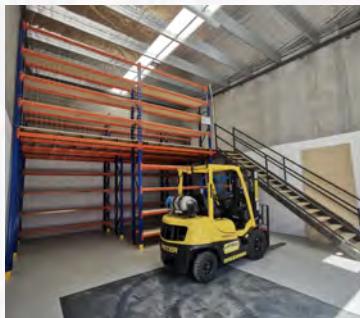

## AUTOMATED STORAGE

- Vertical Carousel
- Mini Load & Pallet ASRS System



# Our Services

**DESIGN  
&  
CONSULTATION**



**RENTALS  
&  
RELOCATION**

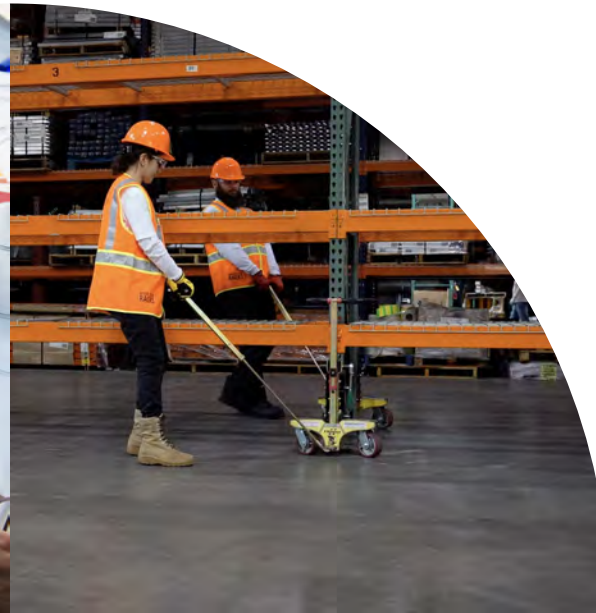

**INSPECTION  
&  
AUDIT SERVICE**



**INSTALLATION  
&  
COMMISSIONING**





# Selective Pallet Racking

- The optimum solution for warehouses with palletized products & a wide variety of SKU'S.
- Direct access to every product.
- Hassel - free stock control: each storage space holds one pallet.
- Adaptable to any space, weight or size of the product.
- Innovative safety locking system prevents accidental or deliberate movement of the beam, ensuring the resilience and stability of the racks.
- Double deep racks can be installed to increase storage facility.
- 100% Accessibility of Unit load.
- 100% Order Picking.
- 30-50% Cubic space utilization.

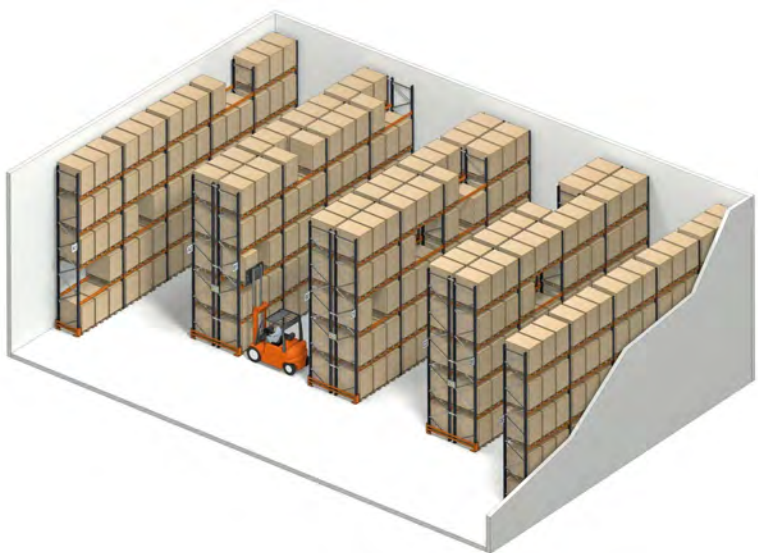



# Drive In Pallet Racking

- Maximum use of available space in terms of surface area and height (leverage space up to 85%).
- Suitable for homogeneous products with a large number of pallets per SKU.
- No aisles between the racks
- Implementation of LIFO (Last in, first out) or FIFO (First in, first out) when there are more than 3 aisles per SKU.
- Ideal for cold storage where maximizing storage space is essential.
- 30% Accessibility of unit load.
- 80% Cubic Space utilization.

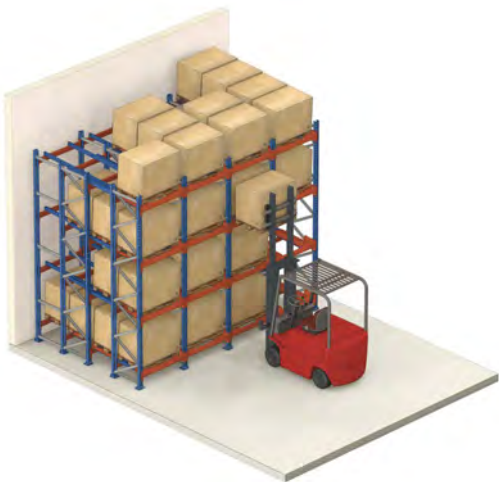



# Double Deep Pallet Racking

- Double deep as the name implies allows the pallets to be stored deep but still accessible from the same aisle. By reducing the number of access aisles and using the space saved to accommodate additional racking. Double deep racking provides a highly space - efficient storage system.
- 50% Accessibility of unit load.
- 45%-60% Cubic space utilization.





# Shuttle System

## Shuttle racking system is particularly well suited to:

- Storing large number of pallets per SKU.
- Either first in, first out (FIFO) or last in, last out (LIFO) storage.
- Ensuring efficient retrieval times.

## It enables you to Minimize damage

### Achieve high density storage

- You can stack pallets far deeper than any other racking, enabling you to really maximize your warehouse space.

### Maintain accessibility

- Despite storage being high density, the shuttle gives you individual access to each storage tunnel.

### Increase productivity

- While the shuttle transports the load to and from the face of the racking and loads the lane, your truck operator is free to work elsewhere, increasing your handling capacity.
- 30% Accessibility of unit load.
- 75% Cubic space utilization.

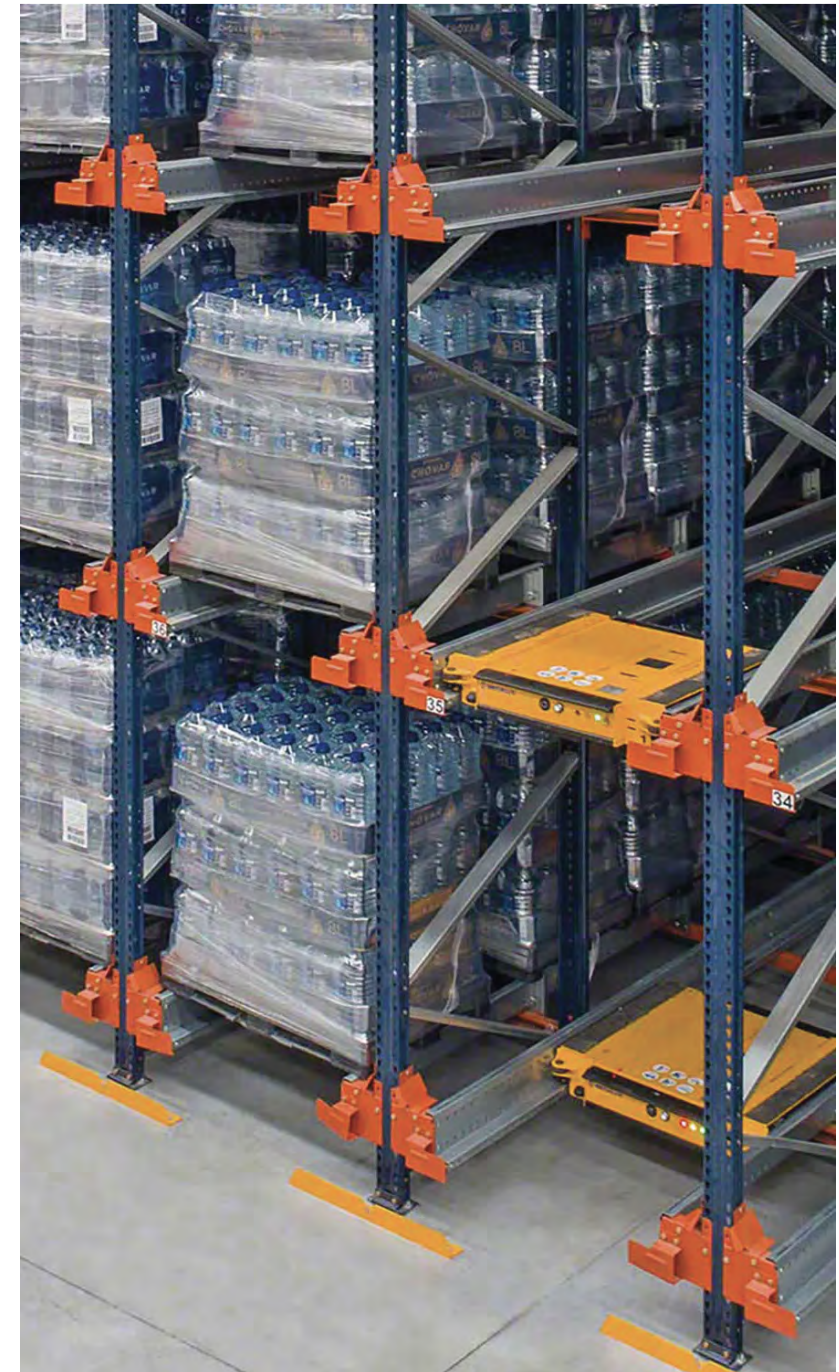



# Mobile Racking

- Mobile Racking System is built on a mobile base and guided by rails on the floor. Driven by an electrical motor, the mobile base move along the rails to open one or more access aisle.
- A high-density storage system, by tapping into the vertical volumetric space, it reduces the warehouse footprint by 45% yet increases the storage capacity by up to 85%. Warehouse owners save on the total building cost of a new warehouse with a faster return of investment.
- 100% Accessibility of unit load.
- 75-80% Cubic space utilization.

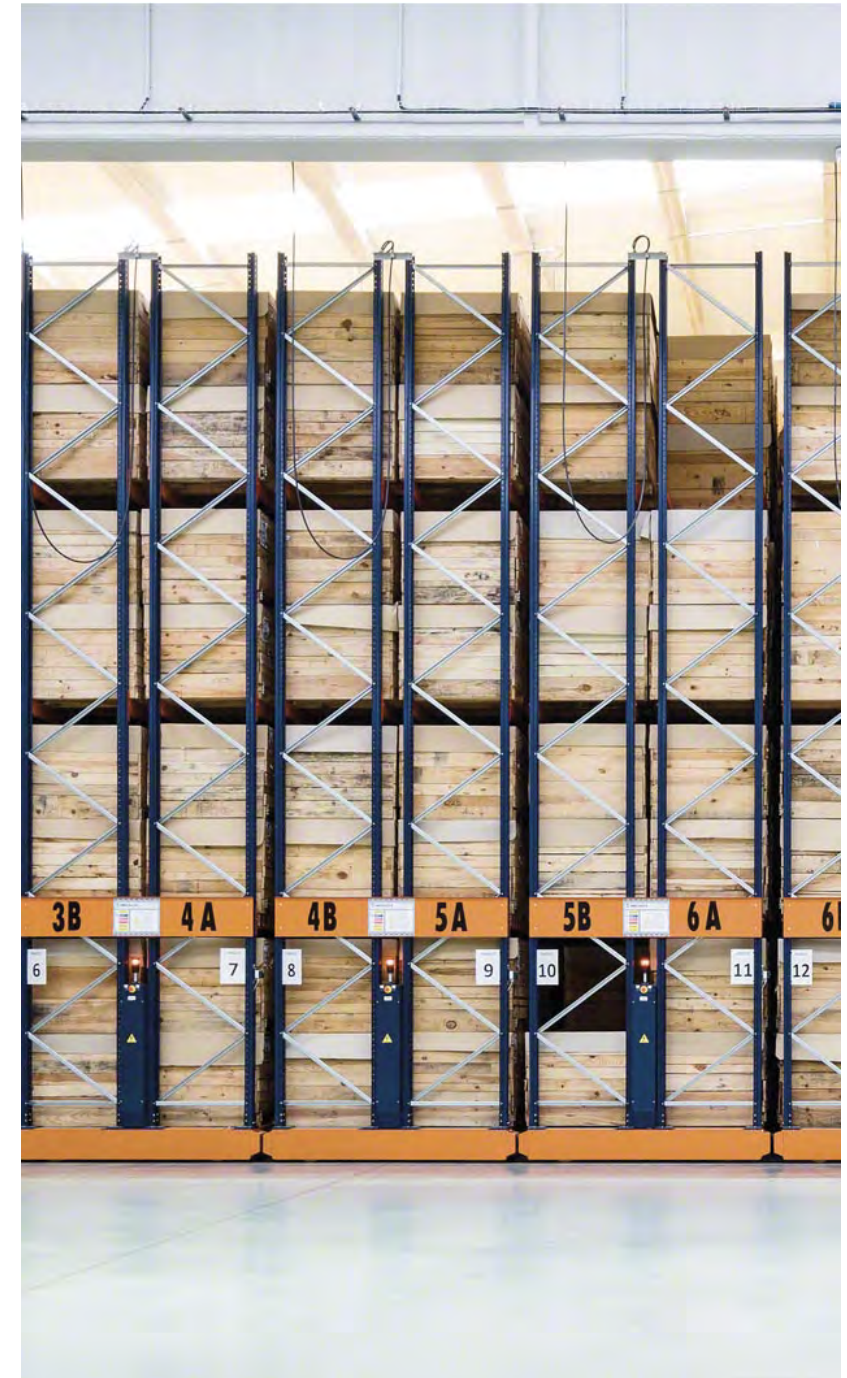



# Slotted Angle Shelving

Slotted angle shelving is the ideal solution for all your bespoke storage requirements. Completely flexible, it lets you make the maximum possible number of bolt connections, no matter what sections you are using.

- Quick and easy to assemble, slotted angle comes in multiple sizes and lengths.
- Can be easily modified as per requirement and can be easily dismantled and re assembled.

## Product Specifications

### Angles available

- 40mm x 40mm and 2mm thick & 60mm x 40mm and 2mm thick

Both are available in standard lengths of 2100mm and 2400mm

### Colour

- Powder coated pepsi blue
- Shelves are galvanized

### Shelving

- Lengths 900mm/ 1200mm & Depths 300mm/450mm/600mm

### Load capacities

- 50kg - 150kg (Depends on the shelving size and duty)





# Long Span Shelving

- Ideal solution for manually storing medium to heavy loads. With a great load resistance, it can support a load capacity of up to 2000kg per shelf.
- It is also suitable for storing varying articles and split rotation, with multiple accessories available for storing products with special shapes such as tires, clothing, spare parts, and more.
- The shelves can reach up to 15m high and are suitable for narrow aisle equipment. Spell check and sentence structure are correct.

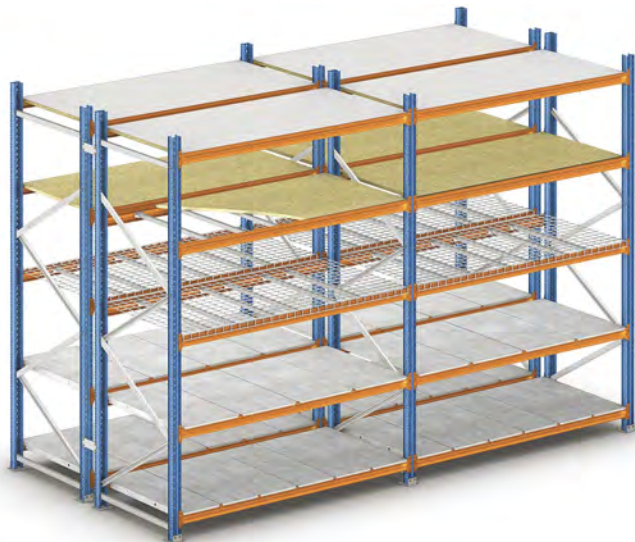



# Boltless Shelving

- Inexpensive, solid and very stable.
- East to assemble, without the use of bolts.
- Perfect finish.
- Highly versatile with the provision to install anywhere, for any business requirement.
- Different models and accessories provide a wide range of solutions for any type of space or product.
- Raised walkways be installed to maximize space usage at different levels, hence doubling the storage area.





# Multi Tier Shelving

- Is a height-based storage solution that utilizes the long span shelving system and is suitable for manual storage in limited spaces.
- This system allows for the maximization of height by creating multiple floor levels, which can be accessed by stairways.
- Load levels can be regulated every 50mm, and there is a choice between metallic or fibreboard panels.
- Additionally, there are various accessories available for storing different types of goods, such as rack dividers, hangers, and mesh panels.

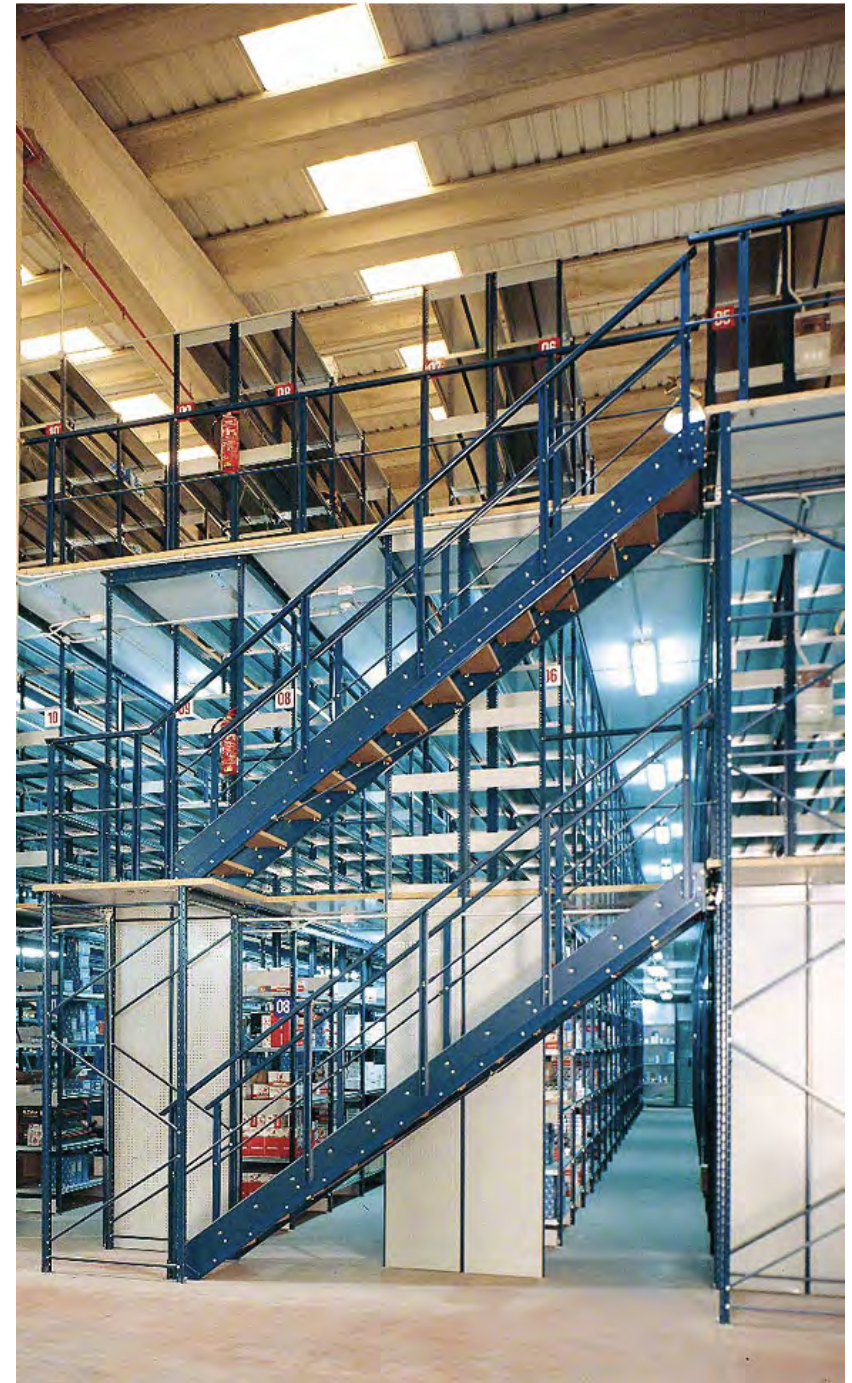
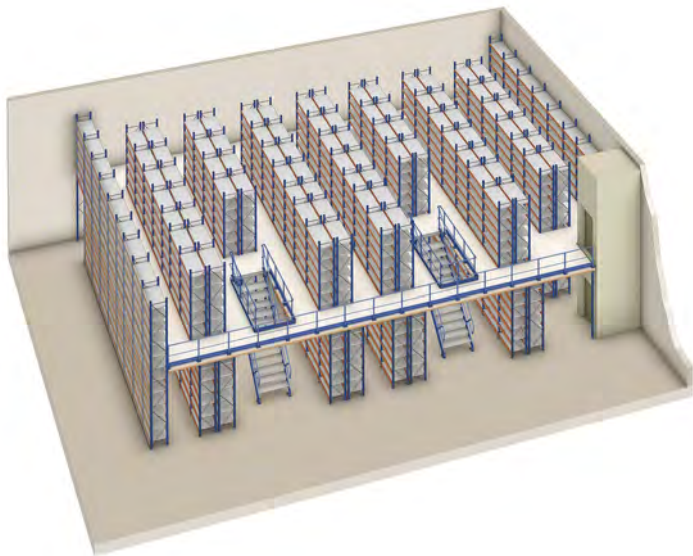



# Cantilever Shelving

- Cantilever racks are a medium to extra heavy-duty storage solution with load-bearing arms anchored to a steel column.
- Cantilever racking is specially designed to store long items or items of varying length.
- It is specifically designed to store long loads such as beams, profiles, pipes and timber.
- Center column design creates unlimited horizontal space purposing.

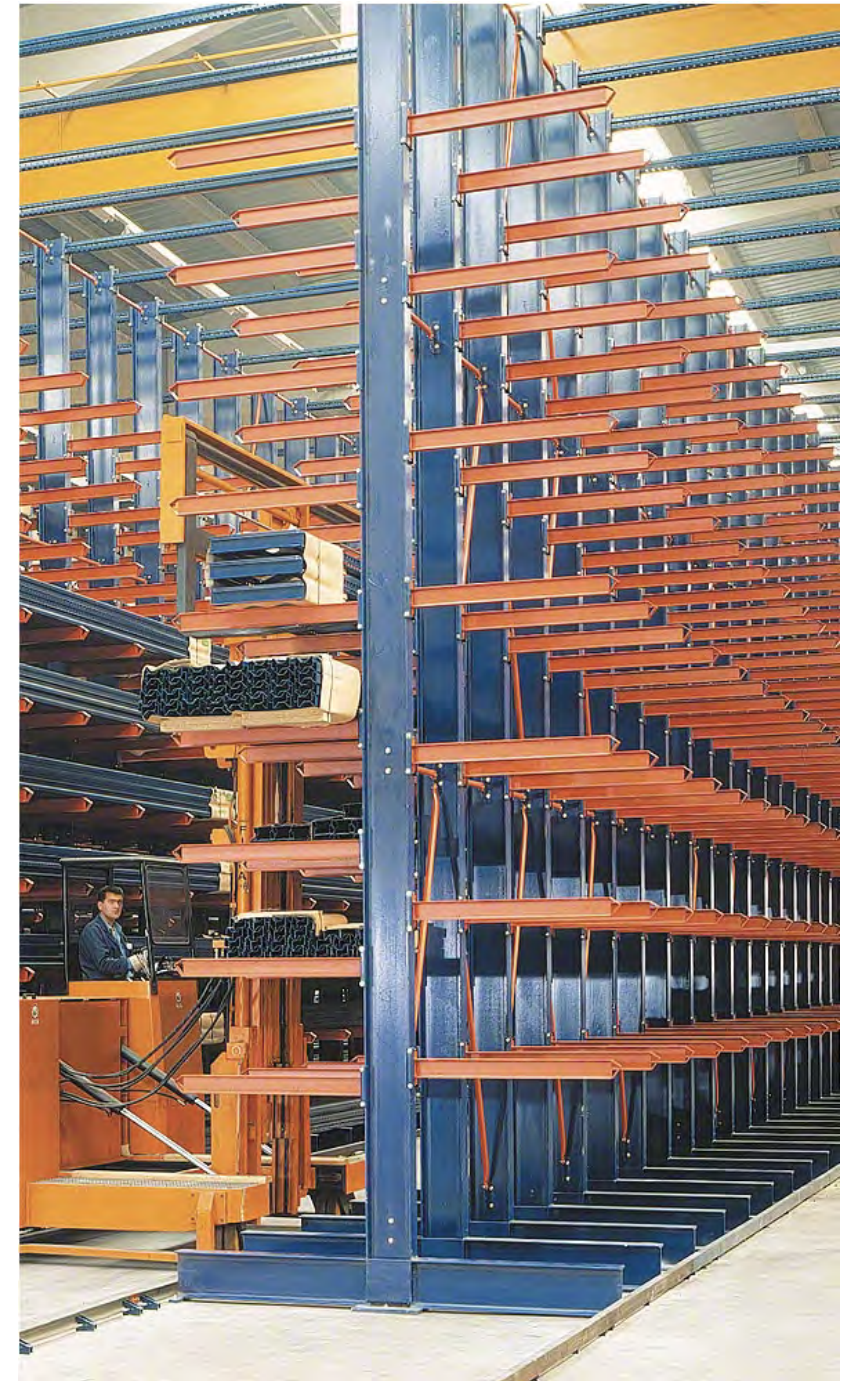
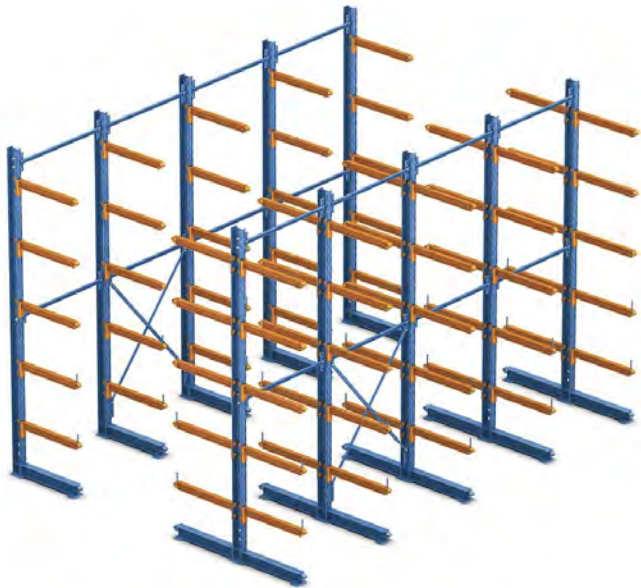



# Mezzanine Structure

Ideal for doubling or tripling surface area. It helps in increasing the usable surface in height by adding one or two levels inside a warehouse.

- Increased surface area of warehouse and stores.
- Great variety of floor sizes and types.
- Quick and simple assembly.

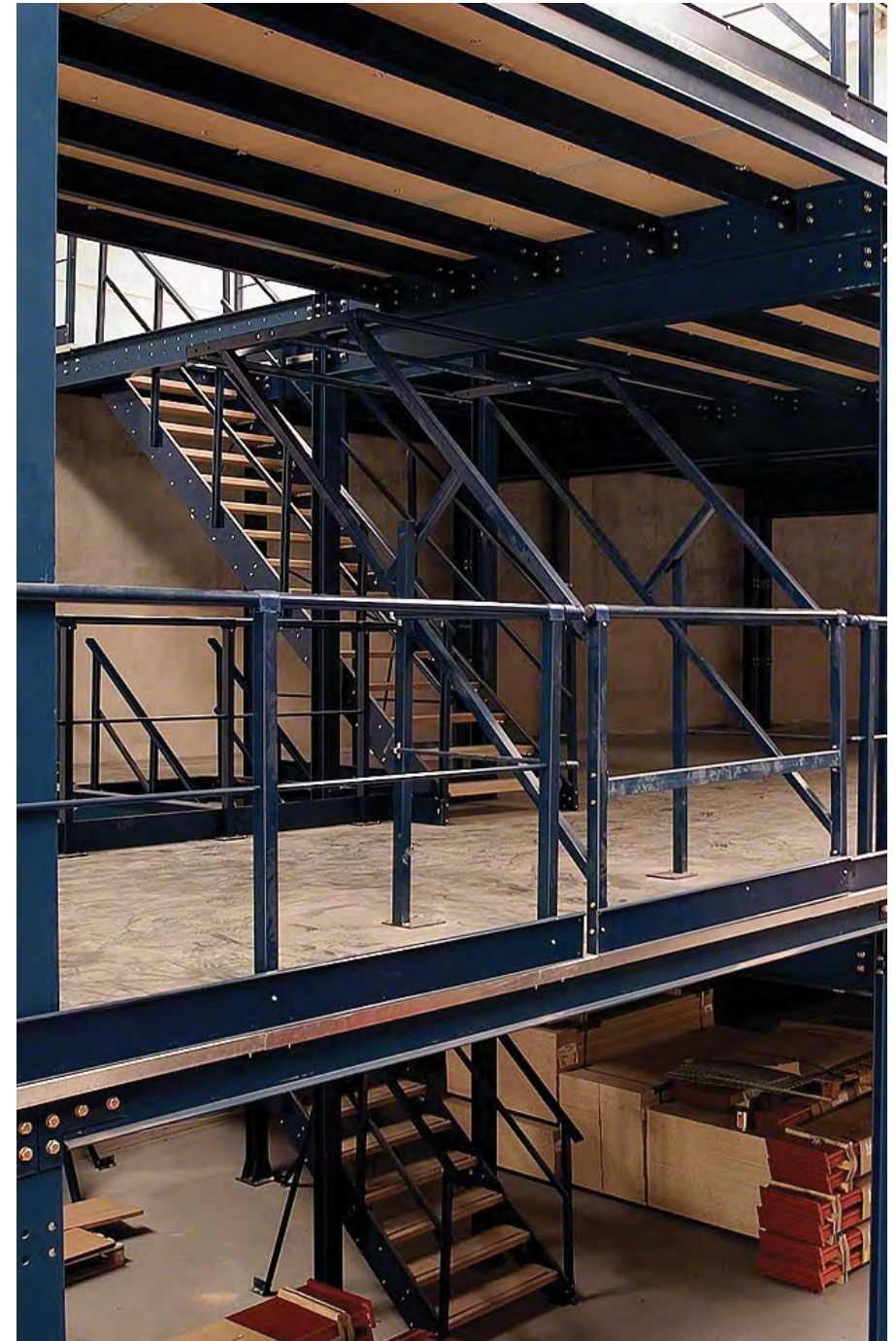
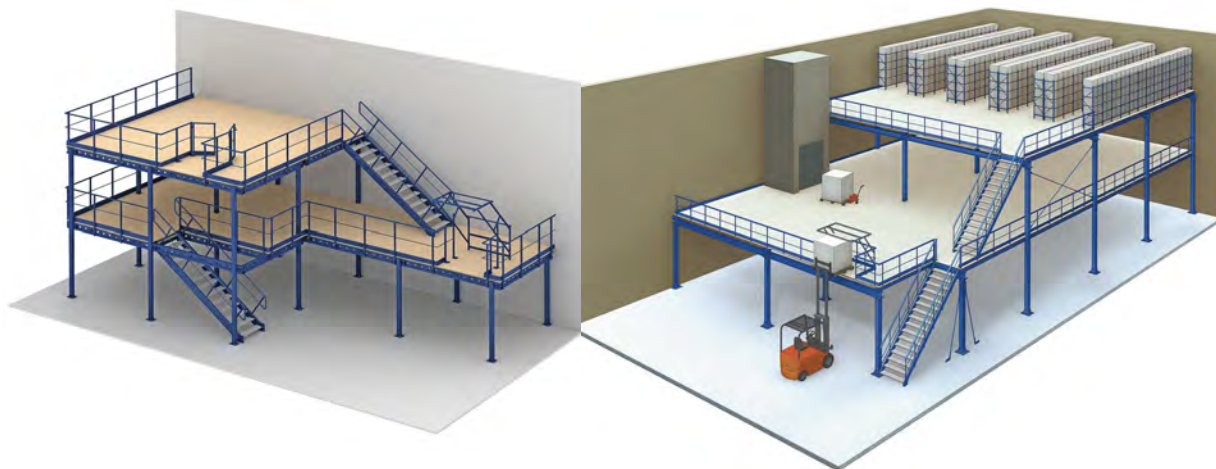



# Our Automated Storage

- Make your warehouse automated to become more competitive.
- Our automated storage solution eliminates the need to manually pick large volume products stored at heights, reducing your picking time and increasing productivity.
- It also provides enhanced safety for both the objects stored inside and the operator.
- This solution is perfect for archiving any large volume storage and is excellent for intensive storage in warehouses.

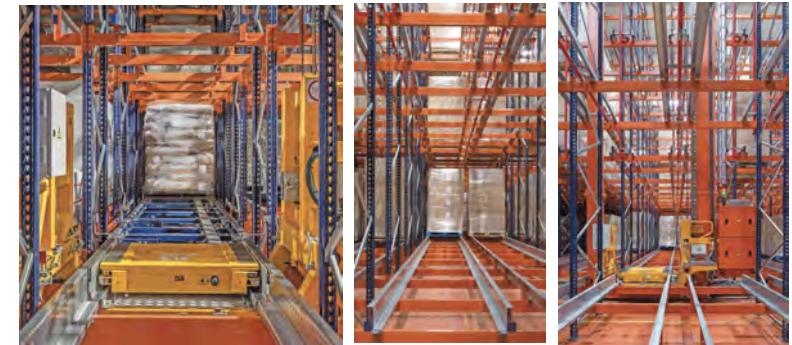
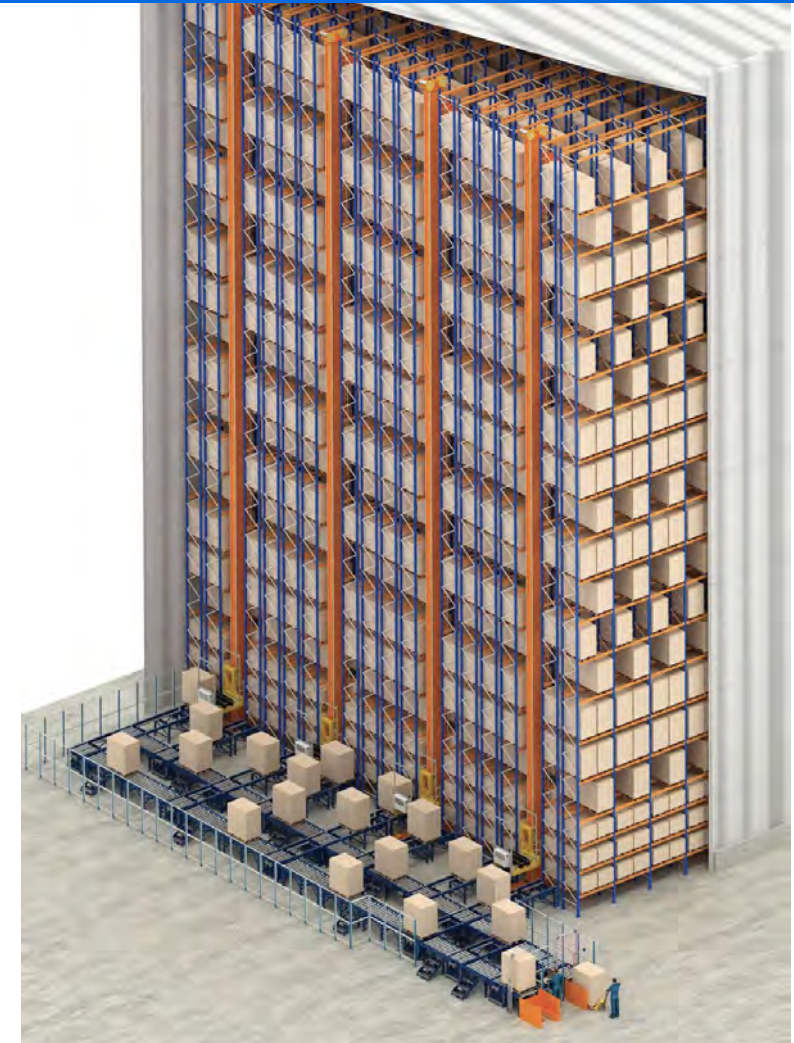
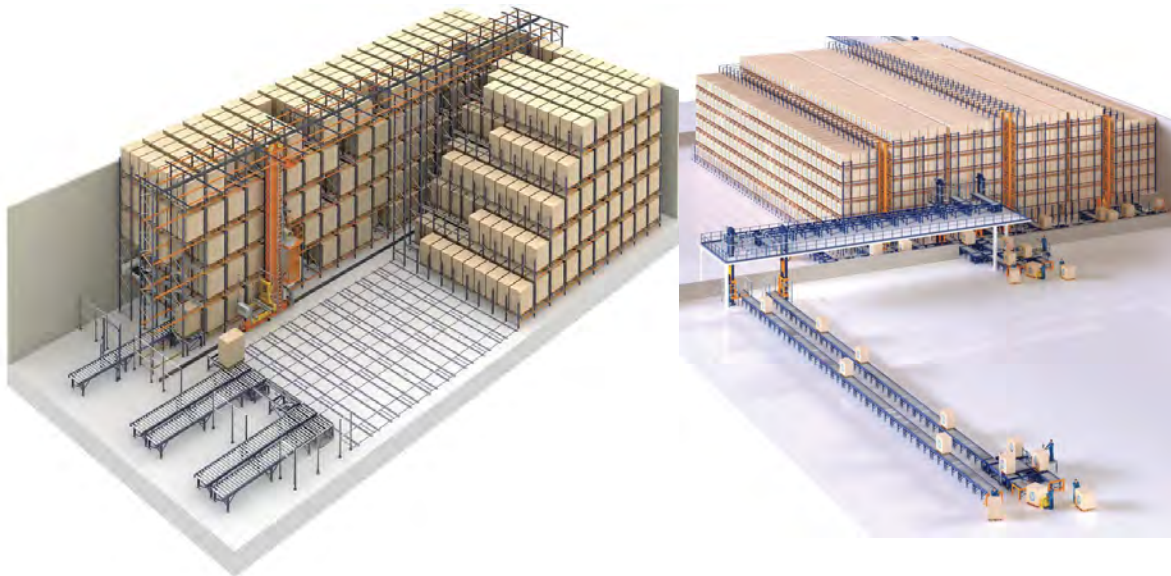



# LOGKRAFT™

REVOLUTIONISING INTRALOGISTICS

[WWW.LOGKRAFT.IN](http://WWW.LOGKRAFT.IN)

+91 9986622281 / +91 9741470470

[ravee@logkraft.in](mailto:ravee@logkraft.in) / [melvin@logkraft.in](mailto:melvin@logkraft.in)

NO 509, 5TH FLOOR, BARTON CENTER, M G ROAD, BANGALORE-560001.